

Mark Stephenson's

ESTATE & LETTING AGENTS



7 Swainsea Drive, Pickering, YO18 8PR

£255,000

- Offered for sale with no onward chain
- Two bedrooms and bathroom
- Gas central heating and uPVC d/glz
- Extremely popular residential area
- Larger than average detached garage
- Realistically priced in order to sell
- Generous dining size kitchen
- South facing rear garden plot

7 Swainsea Drive, Pickering YO18 8PR

7 Swainsea is offered for sale on a completely 'chain free' basis and is located in this now very well established part of town just off Swainsea Lane on the North West side of town. The side door leads immediately a generous dining kitchen, the lounge is also of a good size, there are two rear facing bedrooms and a bathroom with white suite and over bath shower. The rear gardens enjoy a south facing aspect, the driveway leads upto a larger than average detached garage with remote door. Central heating is from a Worcester combi whilst windows are double glazed in uPVC.



Council Tax Band: C



General information

Swainsea Drive is located on the north west edge of town, only a short walk to the centre, there is a regular mini bus service to the centre of town. Pickering is a bustling market town, famous for its castle and steam railway, and located on the southern boundary of the North York Moors National Park and close to the heritage coastline. The town offers a wide range of amenities, including primary and secondary school, sport centre, restaurants, public houses and an array of retailers.

Dining kitchen

With a range of relatively modern base and wall level unit, integrated dishwasher, oven, hob and hood over. Plumbing for washing machine, front and side facing window windows and side entrance door onto the driveway, wall mounted Worcester Comby style central heating boiler, radiator.

Inner hallway

Hatch to the loft.

Lounge

Of a generous size with large front window and radiator beneath, further window to the west side also with radiator beneath, living flame gas fire in traditional style surround.

Bedroom 1

Rear facing window with radiator beneath, full width range of wardrobes.

Bedroom 2

Rear window with radiator beneath.

Bathroom

Relatively modern white three-piece suite including Bath, WC, wash basin, over bath shower, side facing window, tiled to 3 walls and to the floor.

Outside space/gardens

Nicely established lawn garden area at the front with borders and front boundary hedge. A good length driveway to the side gives access to the rear gardens also laid mainly to lawn with timber shed and enjoying a particularly sunny south facing aspect.

Garage

Larger than average size. 22' 6 x 12' wide, sectional construction with power and light connected and with remote operated front door.





Approximate Gross Internal Area 735 sq ft - 68 sq m

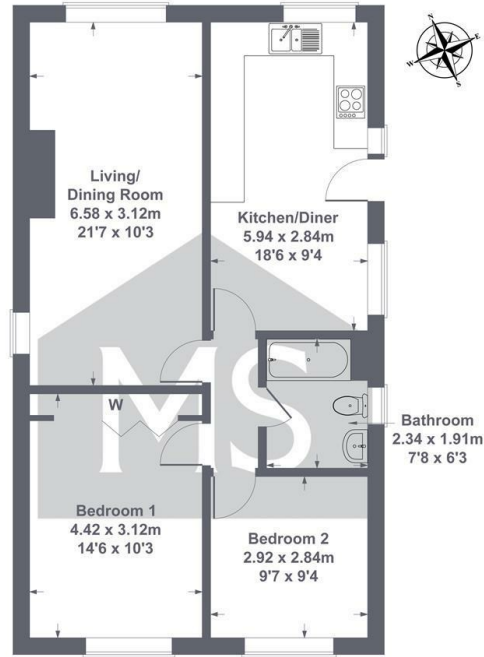

SKETCH PLAN FOR ILLUSTRATIVE PURPOSES ONLY

All measurements walls, doors, windows, fittings and appliances, their sizes and locations, are approximate only. They cannot be regarded as being a representation by the seller, nor their agent.

Produced by Potterplans Ltd. 2026

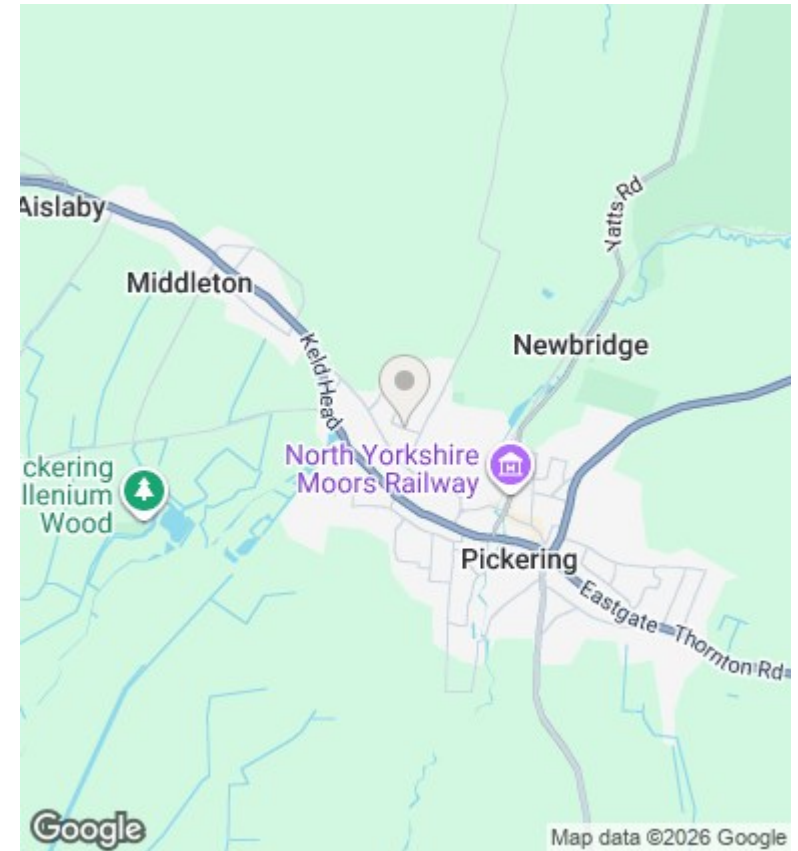

Directions

Viewings

Viewings by arrangement only. Call 01751 476900 to make an appointment.

Council Tax Band

C

Energy Efficiency Rating		
	Current	Potential
<i>Very energy efficient - lower running costs</i>		
(92 plus) A		
(81-91) B		
(69-80) C		
(55-68) D		
(39-54) E		
(21-38) F		
(1-20) G		
<i>Not energy efficient - higher running costs</i>		
England & Wales	EU Directive 2002/91/EC	